

Furrow Close

Cheltenham GL52 3NB



Furrow Close, Cheltenham GL52 3NB

This stunning two bedroom, mid-terraced home was built by Bloor Homes as part of the Prestbury Chase development. The accommodation offers some lovely features which include a good sized lounge, kitchen/breakfast room which offers integrated appliances and patio doors opening on to the well maintained garden, lastly on the ground floor is a downstairs WC and utility room. Upstairs you will find two double bedrooms, an ensuite to the main bedroom and family bathroom. The property further benefits from gas central heating, double glazed windows and two off road parking spaces.





GROUND FLOOR
318 sq.ft. (29.5 sq.m.) approx.

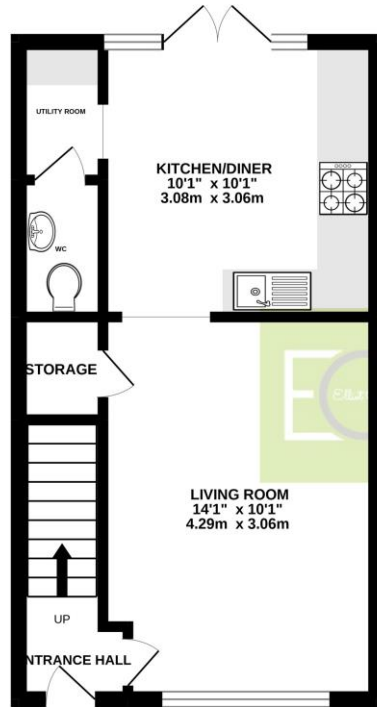

1ST FLOOR
306 sq.ft. (28.4 sq.m.) approx.

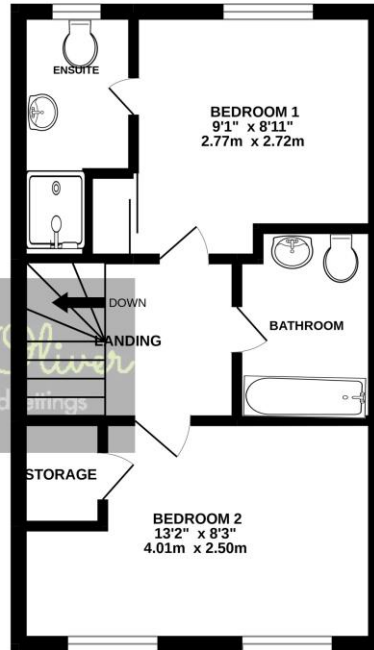

TOTAL FLOOR AREA : 699sq.ft. (64.9 sq.m.) approx.

Whilst every attempt has been made to ensure the accuracy of the floorplan contained here, measurements of doors, windows, rooms and any other items are approximate and no responsibility is taken for any error, omission or mis-statement. This plan is for illustrative purposes only and should be used as such by any prospective purchaser. The services, systems and appliances shown have not been tested and no guarantee as to their operability or efficiency can be given.
Made with Metropix ©2022

Energy Efficiency Rating

	Current	Potential
Very energy efficient - lower running costs		
(92-100) A		98
(81-91) B	84	
(69-80) C		
(55-68) D		
(39-54) E		
(21-38) F		
(1-20) G		
Not energy efficient - higher running costs		
England, Scotland & Wales		EU Directive 2002/91/EC

Address:
Funtow Close



OFFICE

101 Promenade,
Cheltenham,
Gloucestershire, GL50
1NW
info@elliottoliver.co.uk

Agents Note: Whilst every care has been taken to prepare these sales particulars, they are for guidance purposes only. All measurements are approximate and for general guidance purposes only and whilst every care has been taken to ensure their accuracy, they should not be relied upon and potential buyers are advised to recheck the measurements